

BC Broncos Three Point Seat Belt Installation

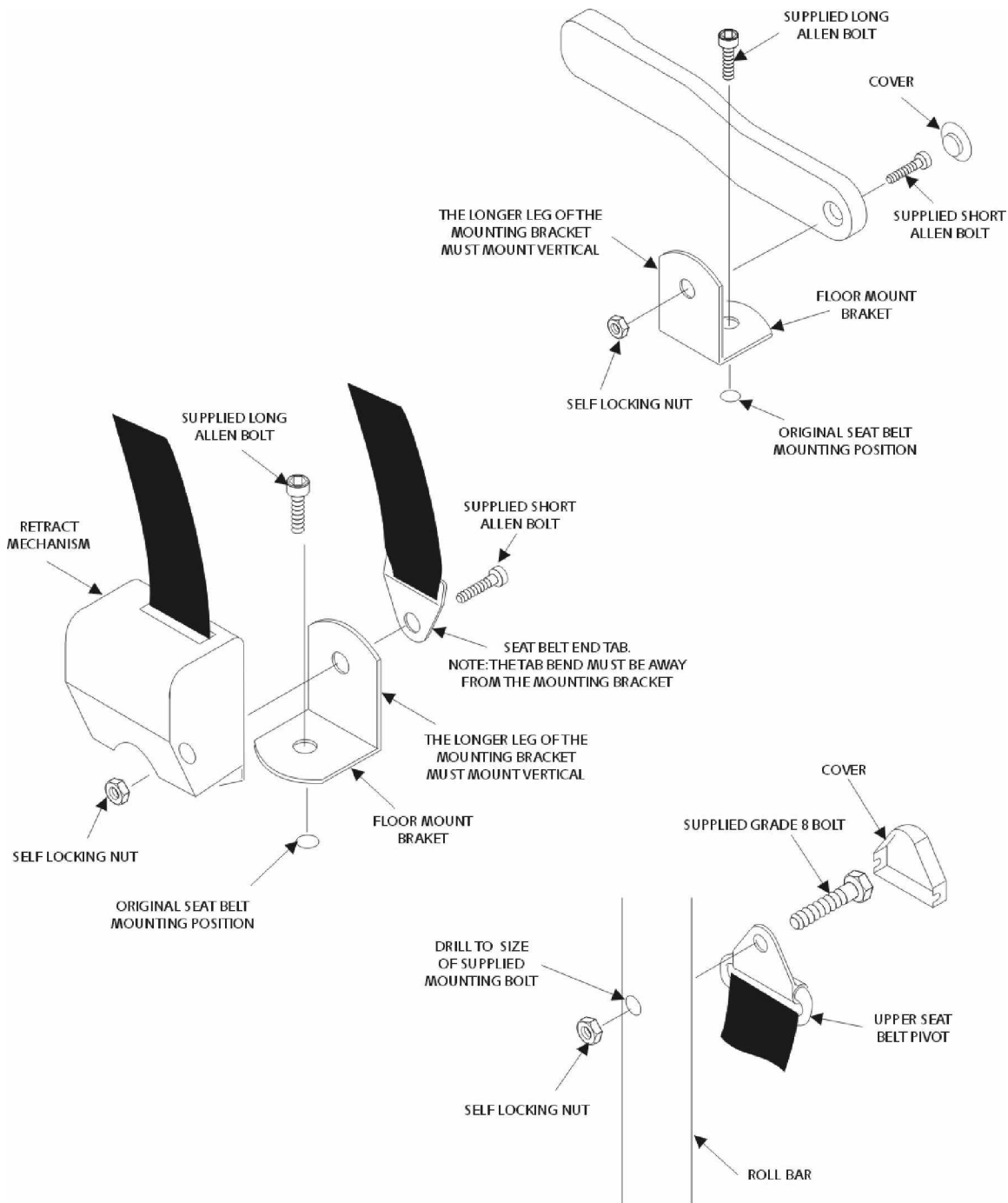

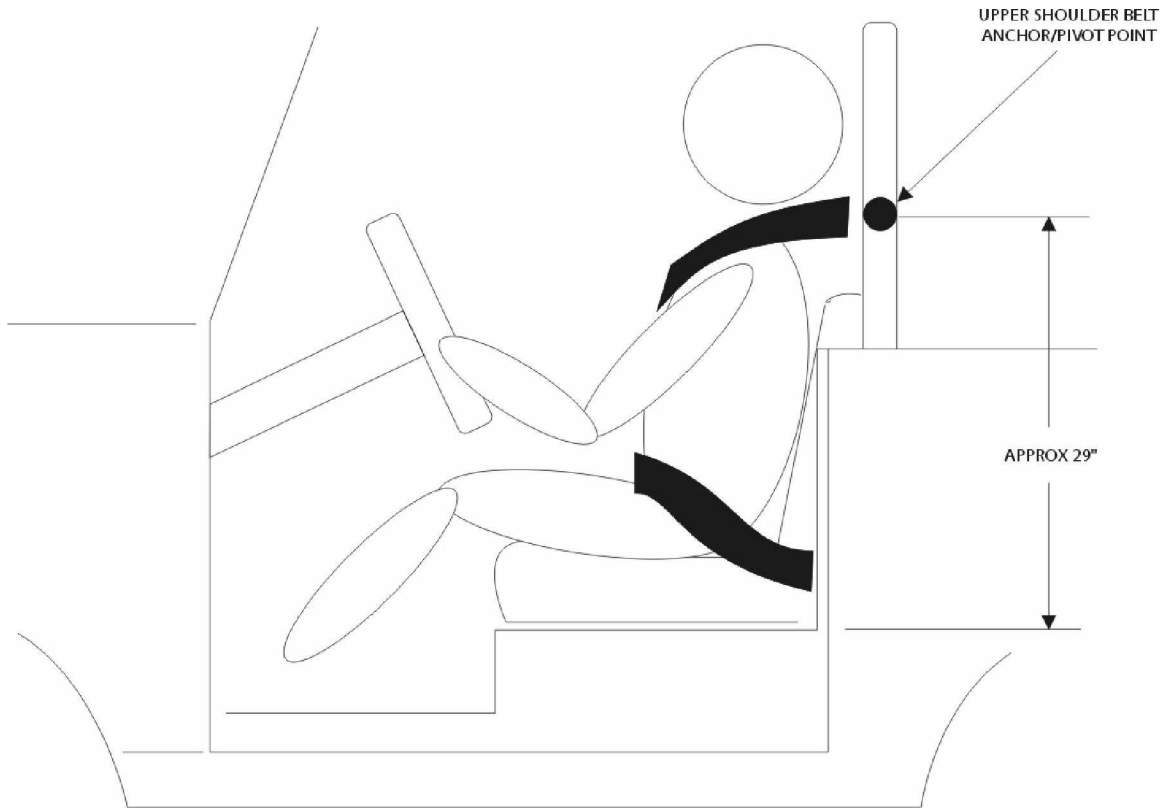

THE UPPER SHOULDER BELT ANCHOR/PIVOT SHOULD BE LOCATED APPROX. 29" OFF OF THE FLOOR. THIS IS ONLY A RECOMMENDATION AND THE FINAL MOUNTING POSITION WILL DEPEND ON THE DRIVERS HEIGHT AND COMFORT.